

PART NUMBER	DESCRIPTION	MATERIAL
FP-HF12-15	FOOT, HF1200	3/8 x 3

REVISIONS			
REV.	DESCRIPTION	DATE	APPROVED
B	REVISED TO 3D MODEL	8/28/2013	
C	ADD SECOND SLOT AND COPED CORNERS	8/13/2018	

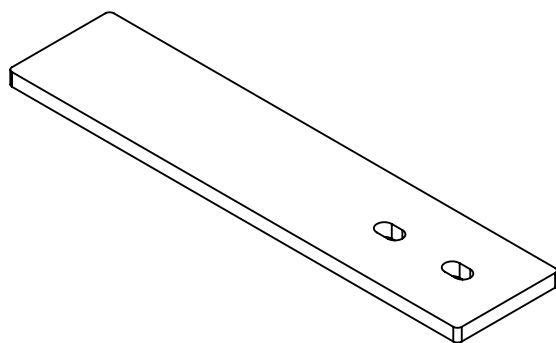
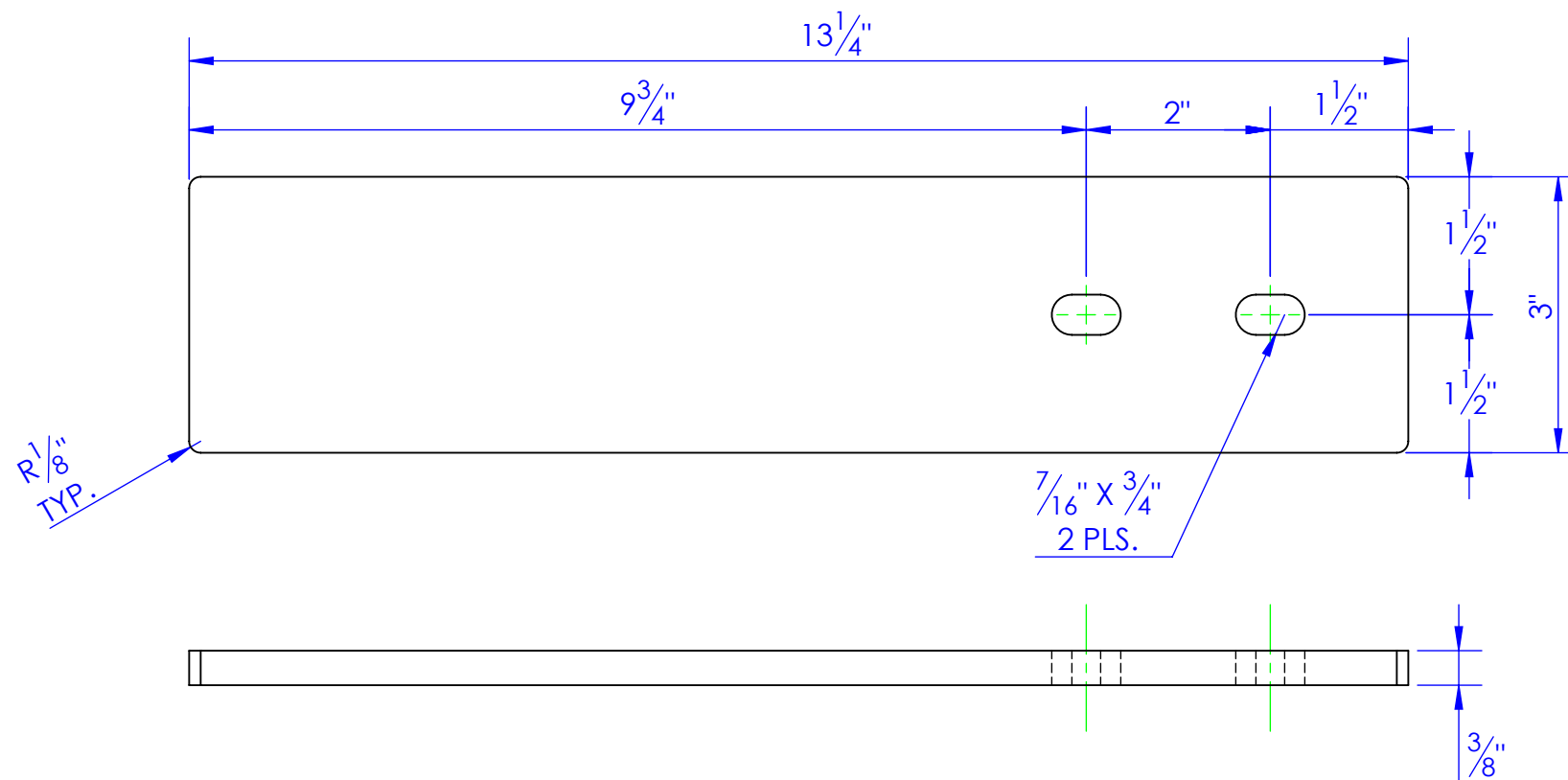

PROPRIETARY AND CONFIDENTIAL
 THE INFORMATION CONTAINED IN THIS
 DRAWING IS THE SOLE PROPERTY OF TRIPLE
 C INC. ANY REPRODUCTION IN PART OR
 AS A WHOLE WITHOUT THE WRITTEN
 PERMISSION OF TRIPLE C INC. IS PROHIBITED.

DIMENSIONS ARE IN INCHES TOLERANCES: FRACTIONAL $\pm 1/16$ ANGULAR: MACH ± 1 BEND \pm TWO PLACE DECIMAL ± 010 THREE PLACE DECIMAL ± 005			NAME	DATE
MATERIAL 3/8 x 3			DRAWN HEATH	8/13/2018
DO NOT SCALE DRAWING			PART # FP-HF12-15	
			ASM #	
			COMMENTS:	
			FOOT, HF1200	

P.O. BOX 248, SABETHA, KS 66534			
TRIPLE C INC.			
SIZE A	DWG. NO.	30-1216 C	
SCALE: 1:2	WEIGHT: 4.17	SHEET 1 OF 1	
			REV. C